

EXECUTIVE SUITE OPTIONS

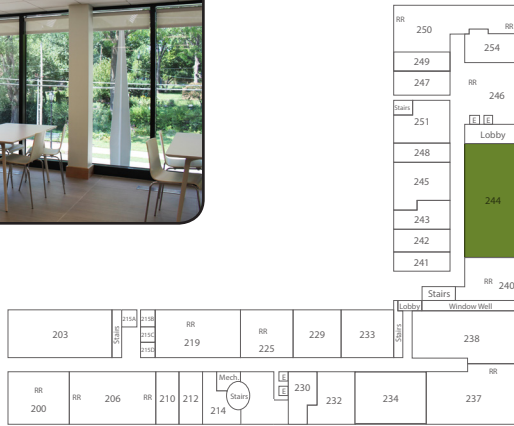

- + Options from \$300 - \$650 per month
- + Quick access to lobby and parking
- + Common-use conference room available
- + Common area coffee bar and lounge area
- + New open concept lobby w. floor to ceiling windows
- + New flooring, wall finishes, and lighting
- + Interior way finding and tenant signage
- + Updated restrooms and common spaces
- + Usable outdoor spaces
- + Significant landscaping additions
- + Improved exterior lighting and facade
- + New monument signage
- + Bike and pedestrian friendly exterior layout



VIEW OF MISSION ROAD



For more information contact:

BROOKE SCHWOB
816.268.9110
bschwob@lane4group.com