

... a neighborhood tradition



New Look. New Ownership.
NEW EXPERIENCE.

RED BRIDGE
SHOPPING CENTER

BRANDON BUCKLEY
816.268.9112
bbuckley@lane4group.com

WESTON BUCKLEY
816.268.9102
wbuckley@lane4group.com

LANE4
PROPERTY GROUP

THE NEW

Red Bridge Shopping Center

... a neighborhood tradition revived

- **MASSIVE RENOVATION COMPLETED FALL 2016**
- **GROCERY, HARDWARE, AND FITNESS ANCHORED**
- **AFFLUENT NEIGHBORHOOD WITH \$107,000 AVERAGE HOUSEHOLD INCOME**
- **THRIVING WORKFORCE: DAYTIME POPULATION OF 138,000 AND RAPIDLY GROWING**
- **OPTIMAL ACCESS: JUST ONE MINUTE FROM I-435**
- **WONDERSCOPE CHILDREN'S MUSEUM EXPECTED TO OPEN IN 2020**



A NEIGHBORHOOD TRADITION REVIVED... Originally developed by the legendary J.C. Nichols Company, the Red Bridge Shopping Center is under new ownership and has recently undergone a massive renovation. Featuring a refined, coastal-inspired architectural flare, the neighborhood center is looking better than ever. Just one minute from I-435 and two minutes from Kansas, Red Bridge boasts outstanding proximity to pivotal neighborhoods, businesses, and schools. Many of Kansas City's largest and most rapidly expanding employers, such as Cerner, Black and Veatch, Freight Quote, St. Joseph Hospital System, and Burns and McDonnell are just minutes away. The center is poised to serve several affluent neighborhoods, including Blue Hills Estates, Hallbrook Farms, and Leawood. St. Thomas More School, Barstow School, Notre Dame de Scion, Rockhurst High School, Avila College, The Keller School of Management, DeVry University, Webster University and the high-achieving Center School District offer outstanding educational opportunities. The numerous employment and education options have spurred an influx of young adults and families to the area.

COME AND SEE THE EXCITING CHANGES AT THE NEW RED BRIDGE SHOPPING CENTER!

an old favorite...

...transformed



- + Redesigned and updated facade
- + New tower elements
- + Significantly improved landscaping
- + Parking lot improvements
- + Additional parking lot lighting
- + New patios and pocket parks
- + New roof
- + New tenant signage
- + HVAC screening



THE NEW

Red Bridge Shopping Center

... a neighborhood tradition revived

Nearby employers, amenities and colleges provide for an outstanding daytime population.

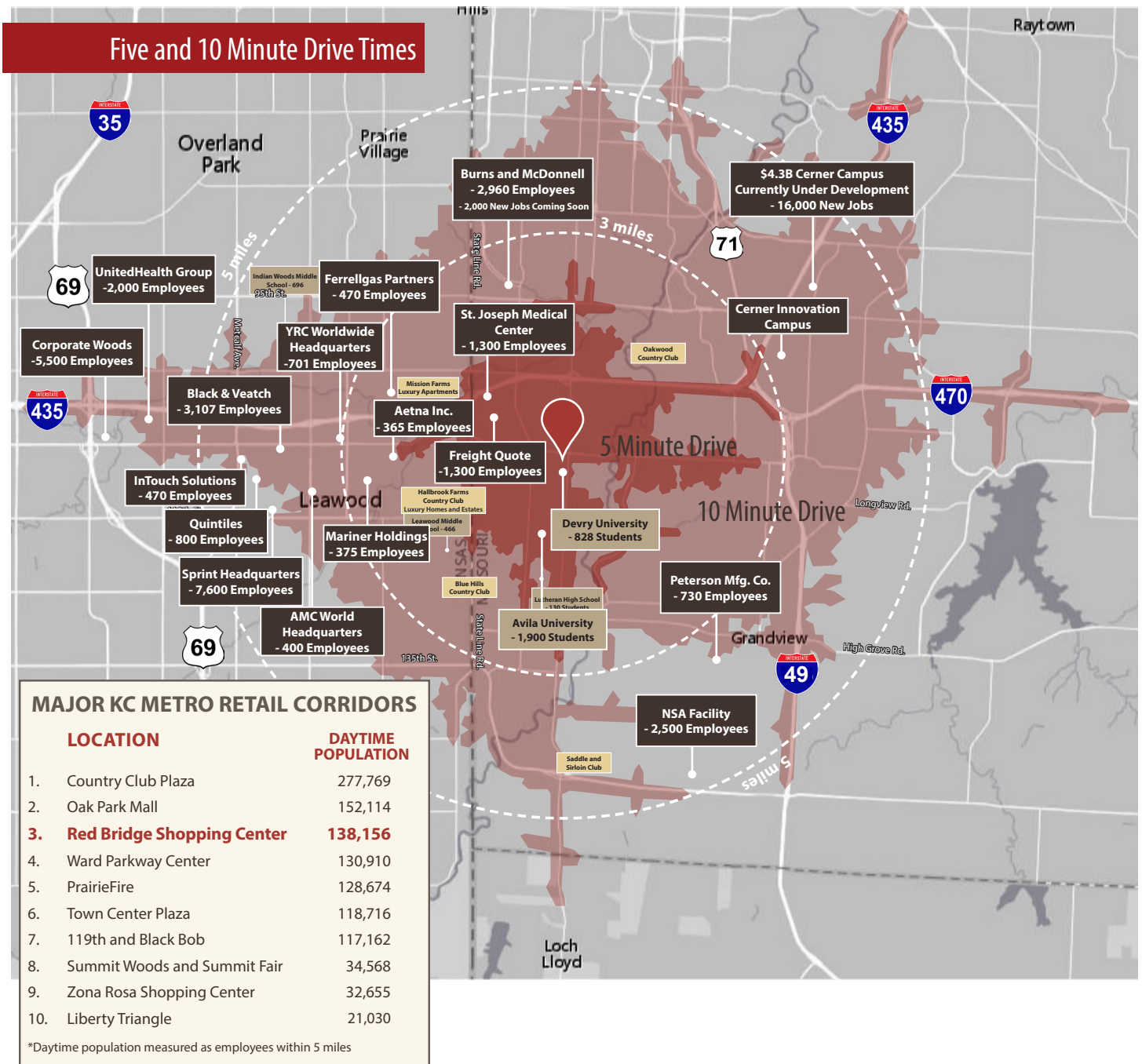

THE NEW

Red Bridge Shopping Center

... a neighborhood tradition revived



AVAILABLE SPACES	
Suite No.	Square Feet
519	1,795
11126	5,893*
11133 A	778

*Space is divisble

Now Open!



Coming 2019:



Coming 2020:



THE NEW

Red Bridge Shopping Center

... a neighborhood tradition revived

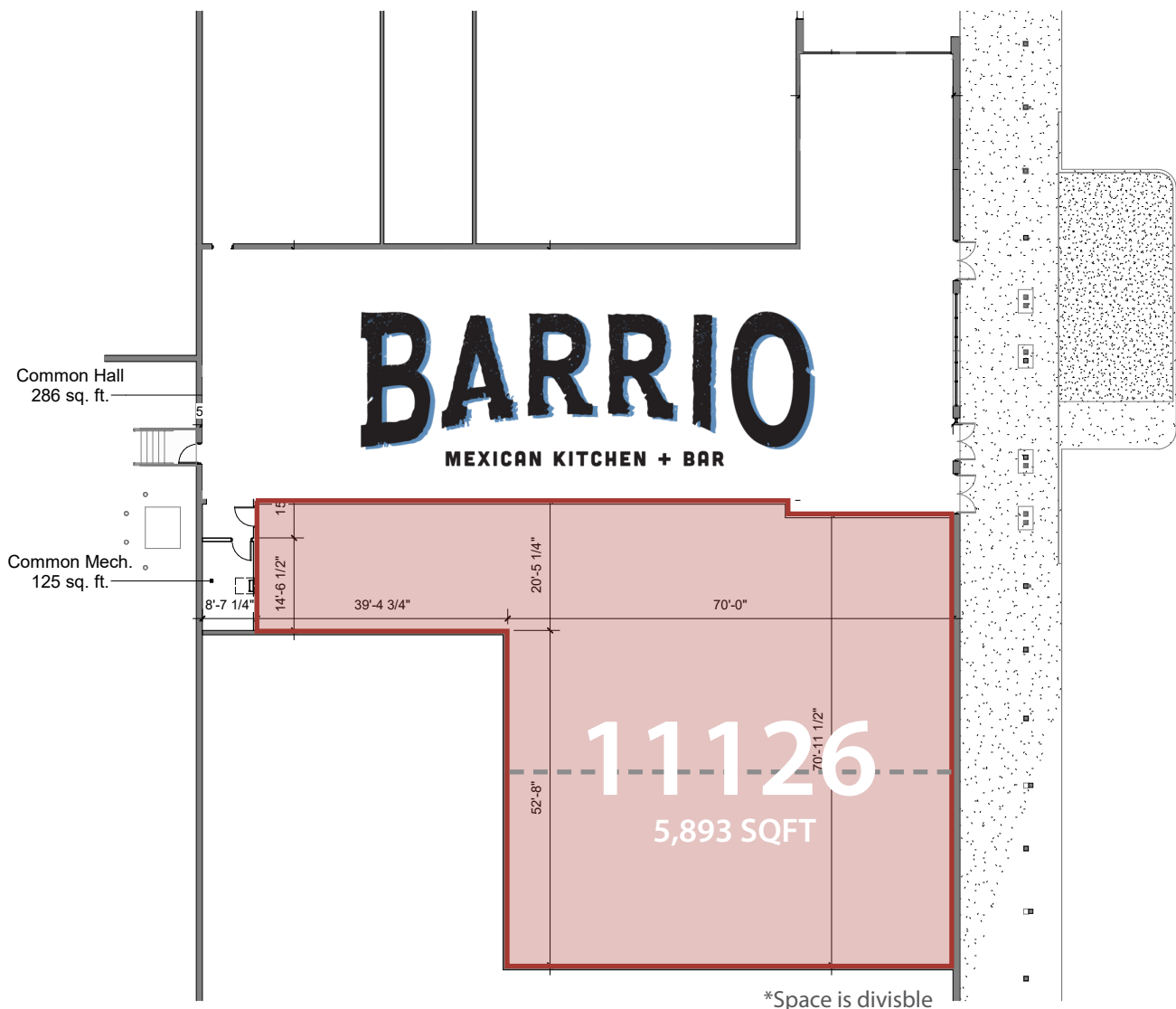

THE NEW

Red Bridge Shopping Center

... a neighborhood tradition revived

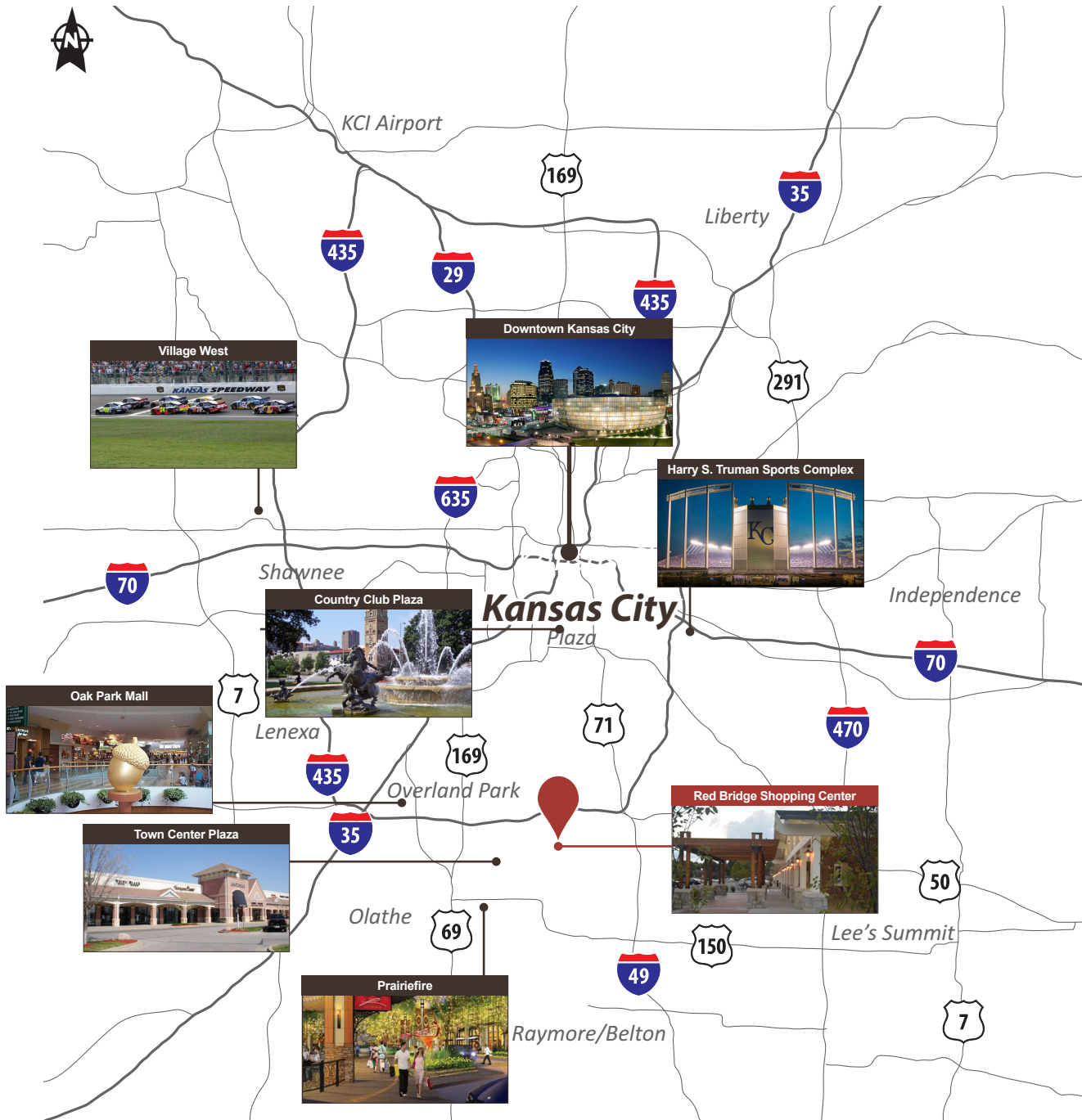

THE NEW

Red Bridge Shopping Center

... a neighborhood tradition revived



Corinth Square Before



Corinth Square After



Corinth Square After



Corinth Square After

Corinth Square: A Success and Inspiration

At LANE4, we specialize in identifying shopping centers currently operating below their potential and turning them into staples of their communities. As an example, in 2012 LANE4 completed a redevelopment of the Corinth Square Shopping Center in Prairie Village, Kansas. The overhaul of Corinth included extensive upgrades and enhancements to both the façade and tenant mix. Today, the shopping center is the home of several popular neighborhood-oriented restaurants and businesses and serves as a bustling gathering place for the surrounding communities.

When we examined the neighborhoods in south Kansas City, it was clear that they were long overdue for a destination where community members could shop, dine and socialize in close proximity to their homes. Red Bridge Shopping Center, originally developed by the J.C. Nichols Company, the same visionary developer that created Corinth Square and the Country Club Plaza, was the clear choice for that destination.

We look forward to replicating the success of our Corinth Square renovation, by bringing in exciting, community-oriented restaurants and shops, and embarking on a bold renovation that will preserve and enhance the historic qualities of the center.