

# OFFICE SPACE AVAILABLE PRAIRIE VILLAGE, KS

LANE4

7301 MISSION RD • OFFICE CENTER



VILLAGE  
OFFICE  
CENTER

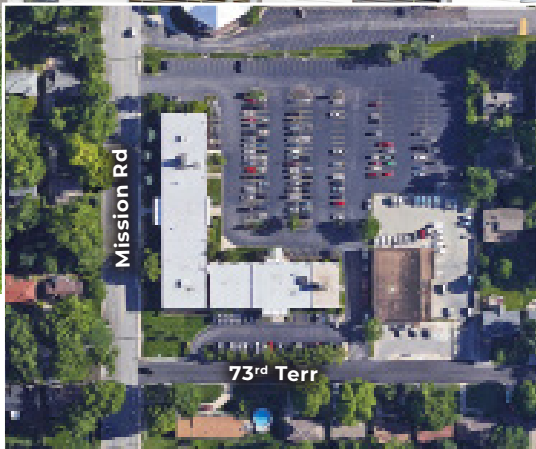

**SPENCER STEWART**  
816.268.9103 / [sstewart@lane4group.com](mailto:ssewart@lane4group.com)



VILLAGE  
OFFICE  
CENTER



- Flexible suite sizes available: 259-4,386 SF for lease
- Executive Suites range in size from 87-203 SF
- Strong medical co-tenancy with ~60% of building occupied by medical users
- Ideal location on Mission Road between The Village Shops and Corinth Square Shopping Center
- Interior/exterior updates and renovations recently completed
- Walking distance to nearby shops, restaurants, and services



# VILLAGE OFFICE CENTER



Available 10/1/2026



## FIRST FLOOR

## SECOND FLOOR

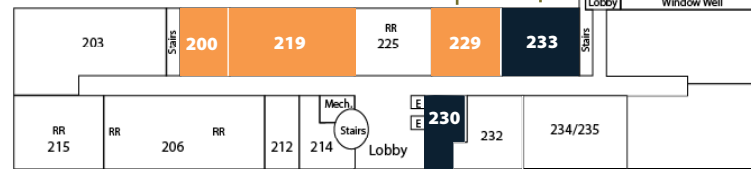

## SECOND FLOOR

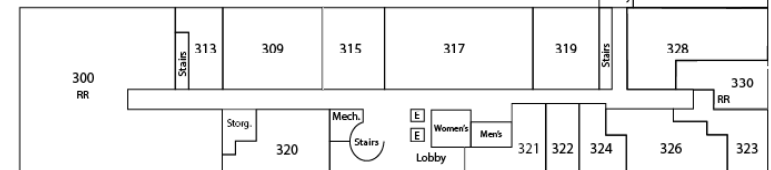

## THIRD FLOOR

[Click on Vacancy to View Virtual Walkthrough](#)

Suite	SF
100	4,386
147	259
200	573
219	1,417
229	924
230	485
233	763
249	451

- Combine up to 1,990 SF
- Combine up to 1,687 SF - 2nd gen dentist space





## EXECUTIVE SUITE OPTIONS

- \$450 - \$800 per month (internet included)
- Common-use conference room, coffee bar and lounge area available
- Open concept lobby with floor to ceiling windows
- Interior way finding and tenant signage
- Usable outdoor spaces; bike and pedestrian friendly exterior layout



VILLAGE  
OFFICE  
CENTER

# PRAIRIE VILLAGE SUBMARKET

