



**SITE**

BANK UNDER  
CONSTRUCTION

ASCEND  
CHURCH



17,446 CPD

10,249 CPD

159<sup>th</sup> St

RIDGEVIEW RD

Olathe New Life  
Community Church

**1.73 AC**

**AVAILABLE**

# 159<sup>TH</sup> & RIDGEVIEW RD

## LAND FOR SALE

NWC 159<sup>TH</sup> & RIDGEVIEW RD • LAND FOR SALE • OLATHE, KS

**ANDREW SANDBURG**  
816.268.9111 / [asandburg@lane4group.com](mailto:asandburg@lane4group.com)

## PROPERTY HIGHLIGHTS

- 1.73 AC available along 159<sup>th</sup> St & Ridgeview Rd
- Located in a rapidly growing area of Olathe with a variety of residential, industrial, and office projects underway
- Excellent visibility to 159<sup>th</sup> & Ridgeview with over 25,000 cars per day
- Affluent area with household income ranging from \$110,000 - \$125,000+

DEMOGRAPHICS	1 MI	3 MI	5 MI
Population	12,497	56,304	133,515
Avg. HH Income	\$113,849	\$107,840	\$128,077
# of Businesses	356	1,797	3,805
# of Employees	3,872	27,501	52,654

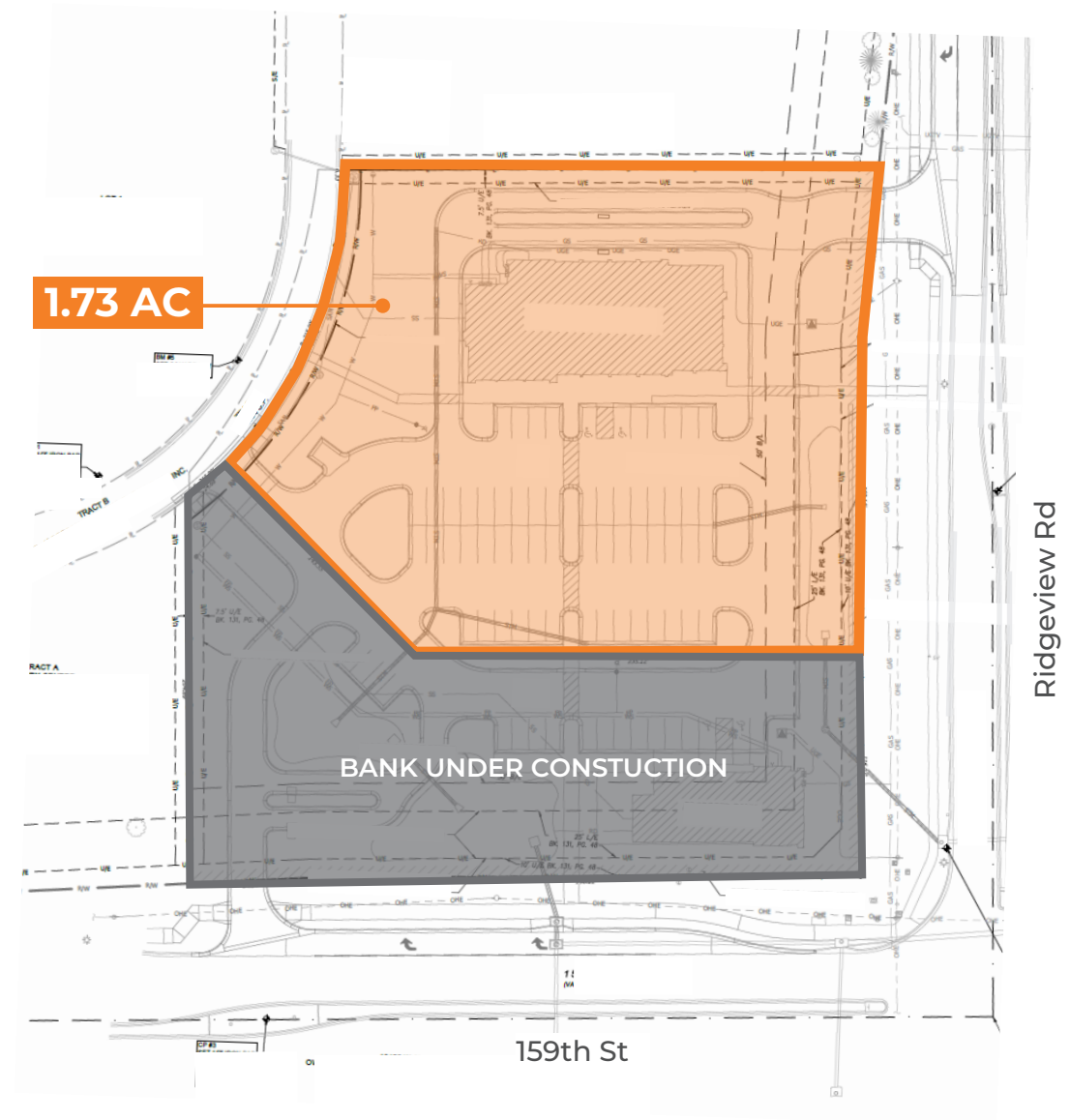



## NEW AND PROPOSED PROJECTS:

- 1 Great Plains Commerce Center
- 2 Lone Elm Commerce Center
- 3 \$110M Distribution Center for Smithfield Foods
- 4 383-lot residential Parkside Reserve subdivision
- 5 175th St Commerce Centre
- 6 Residential Single-Family / Residential Low-Density Multifamily and Commercial
- 7 Annex of 156 AC (use not disclosed)

