

1,100 - 3,960 SF  
AVAILABLE



# DAVITA CENTER

## RETAIL/OFFICE SPACE FOR LEASE

831 EISENHOWER RD • RETAIL CENTER • LANSING, KS

**CHASE GLAESER**

816.268.9110 / [cglaeser@lane4group.com](mailto:cglaeser@lane4group.com)

**ANDREW SANDBURG**

816.268.9111 / [asandburg@lane4group.com](mailto:asandburg@lane4group.com)



## PROPERTY HIGHLIGHTS

- Retail and Office Space available for lease:
  - **1,100 SF** former salon space
  - **1,200 SF** former office space
  - **3,960 SF** former chiropractic/physical therapy space
- Great visibility to Eisenhower Rd with over 14,000 CPD
- Ideally positioned between Main St retail corridor and anchor grocers
- \$116,000+ average HH income within 1-mile of center
- DaVita Shopping Center sees **90,700 visits per year**, with an **average dwell time of 54 minutes**

Source: Placer.Ai (2025)

DEMOGRAPHICS	1 MI	3 MI	5 MI
Population	5,122	29,222	45,571
Avg. HH Income	\$116,732	\$98,225	\$91,670
# of Businesses	130	724	1,330
# of Employees	2,129	10,168	15,826

## SITE PLAN

### AVAILABILITY

SUITE	SF
C	1,100
E	1,200
I	3,960

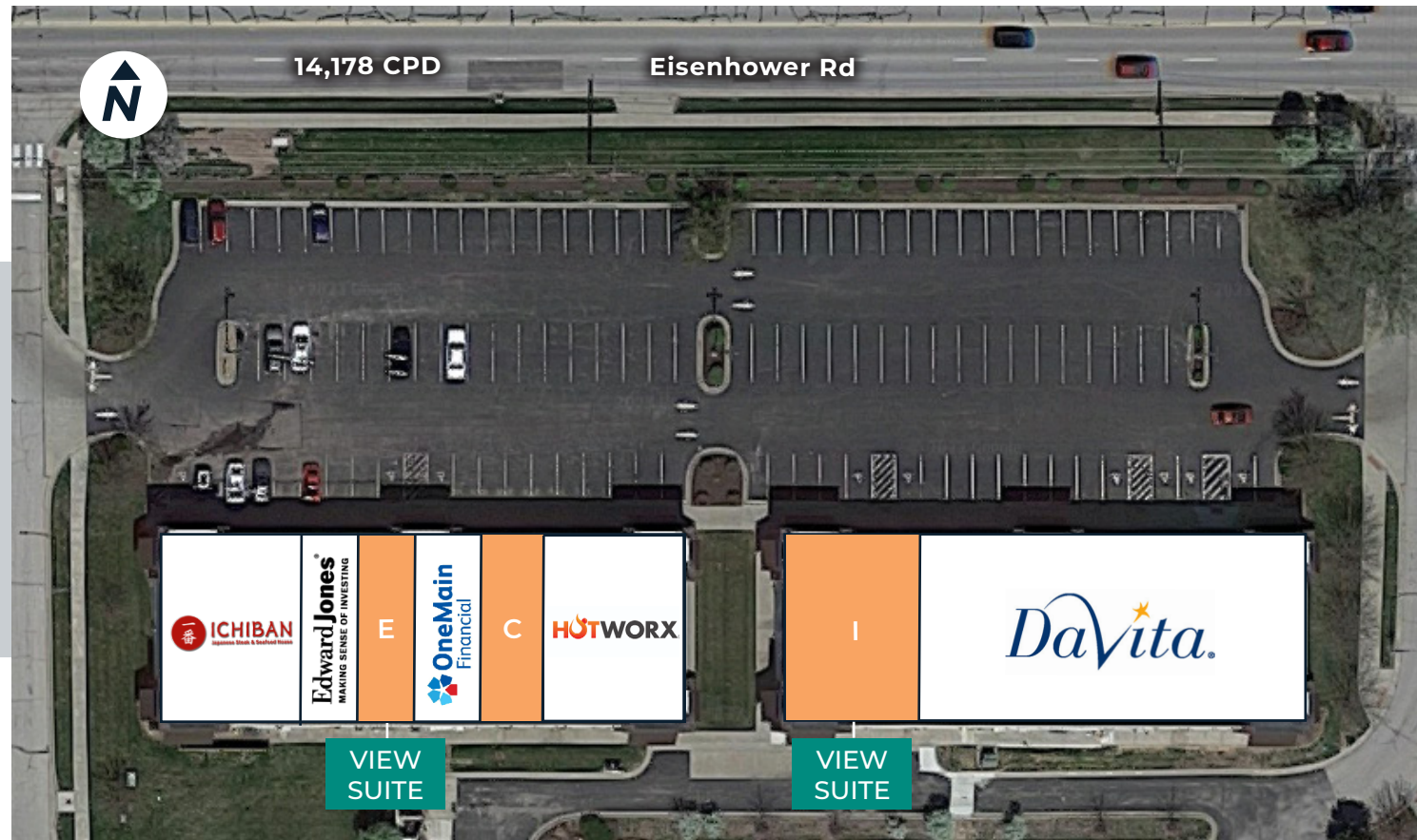

## FLOOR PLANS

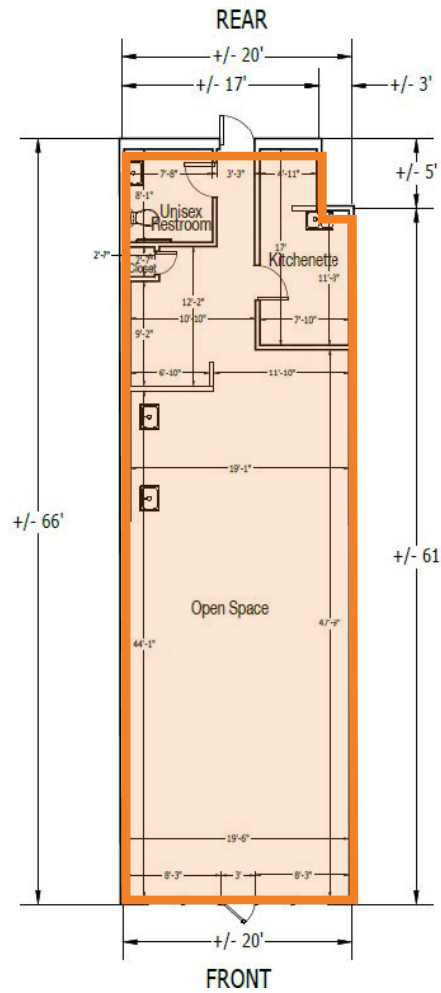

**SUITE C**  
1,100 SF

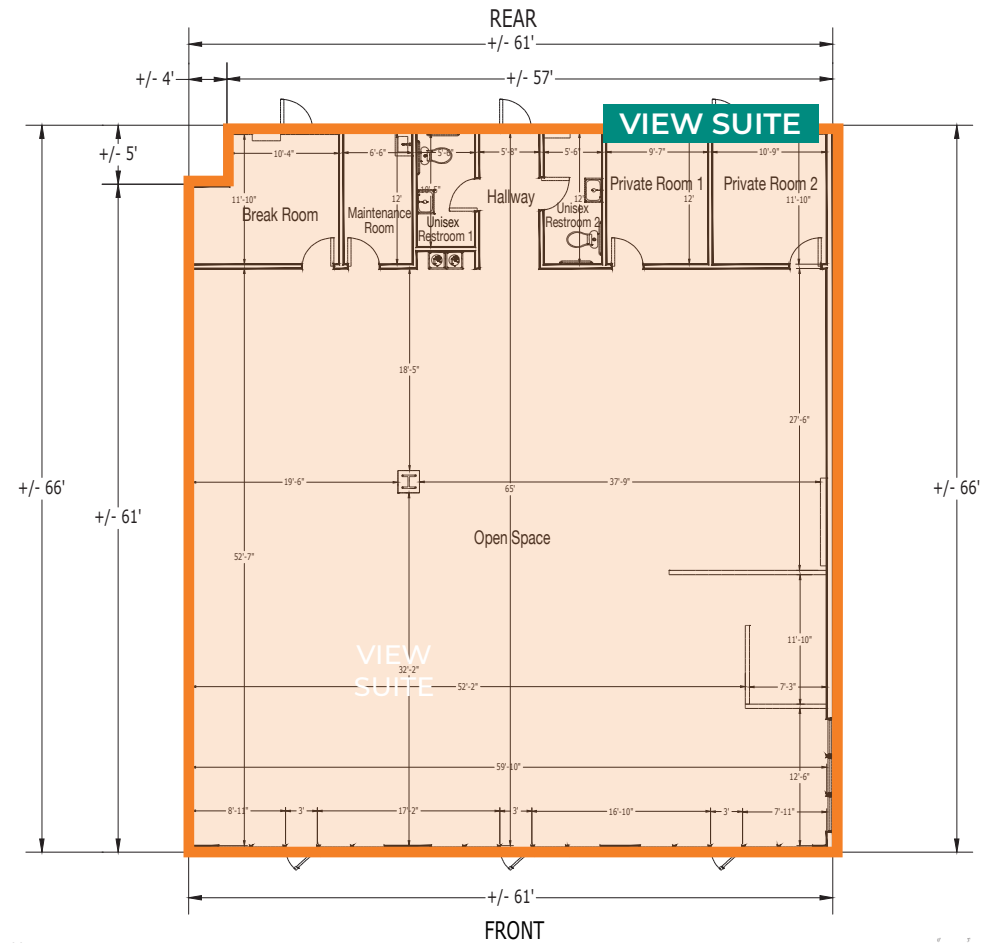

**SUITE I**  
3,960 SF

