

900 &
1,155 SF

AVAILABLE

INDIAN TRAILS SHOPPING CENTER

1461-1505 E 151st ST • RETAIL CENTER • OLATHE, KS

CHASE GLAESER
816.268.9110 / cglaeser@lane4group.com

ANDREW SANDBURG
816.268.9111 / asandburg@lane4group.com

PROPERTY HIGHLIGHTS

- 900 SF & 1,155 SF available for lease
- Located across from Olathe South High School and Garmin Headquarters
- Immediate access to I-35 and 151st St with over 29,900 CPD
- Located in a rapidly growing area of Olathe
- Affluent residential area with average household income ranging from \$113,000 - \$133,000+

DEMOGRAPHICS	1 MI	3 MI	5 MI
Population	11,886	74,658	157,195
Avg. HH Income	\$113,415	\$114,760	\$133,221
# of Businesses	416	2,965	4,586
# of Employees	5,349	42,001	64,340

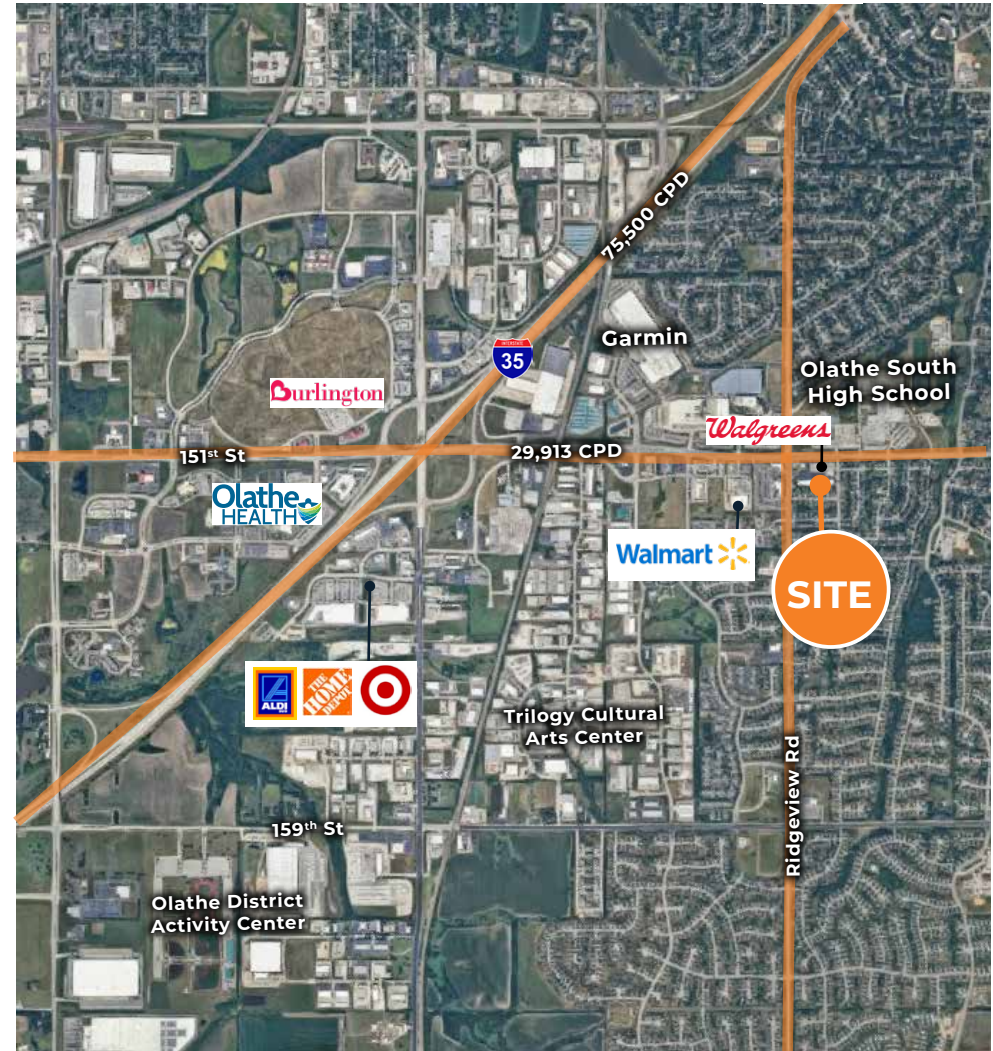

SITE PLAN



STE	TENANT	SF
1461	Olathe Karate Academy	
1463	Woodroof Chiropractic	
1465	Prana Nutrition	
1467-69	Olathe Dance Center	
1471	Bo Bo Chinese	
1473-83	Anytime Fitness	
1485	AVAILABLE	1,155 SF
1487	LSI Staffing Group	
1491	Mochini	
1493	Kumon Learning Center	
1495	AM Taylor	
1497	AVAILABLE	900 SF
1499	Jackson Hewitt	
1501	Daylight Donuts	
1503-07	Lumpy's	

FLOOR PLAN

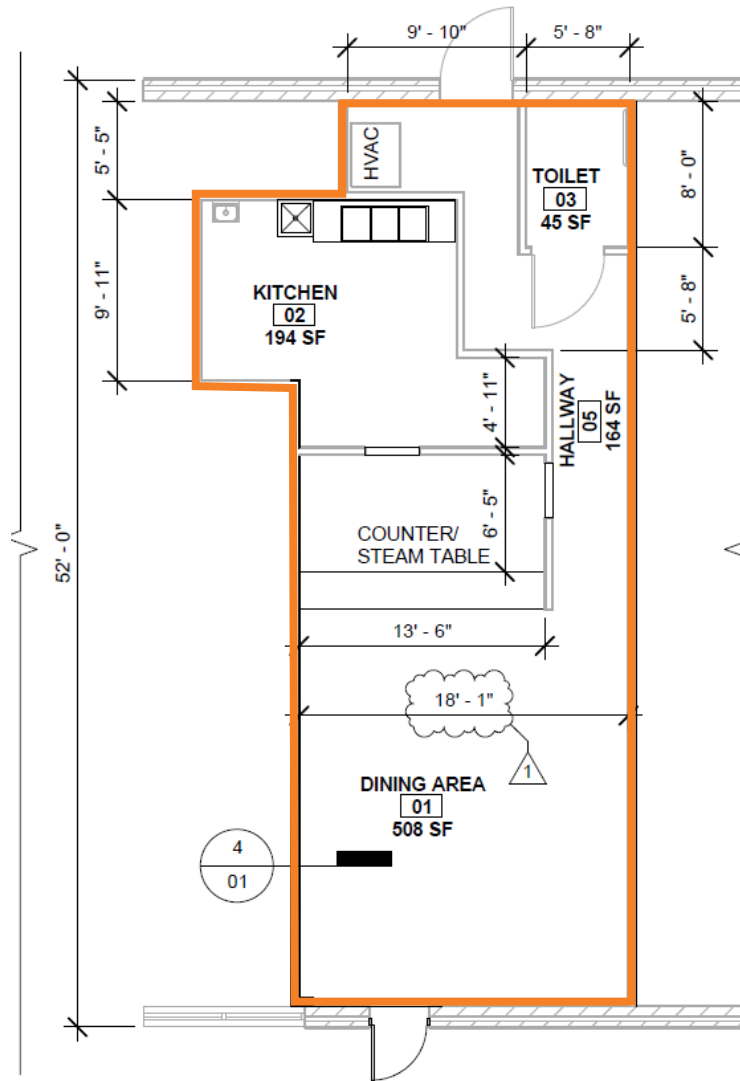

SUITE 1485

1,155 SF

AERIAL OVERVIEW

NEW AND PROPOSED PROJECTS:

- 1 Great Plains Commerce Center
- 2 Lone Elm Commerce Center
- 3 \$110M Distribution Center for Smithfield Foods
- 4 383-lot residential Parkside Reserve subdivision
- 5 175th St Commerce Centre
- 6 Residential Single-Family / Residential Low-Density Multifamily and Commercial
- 7 Annex of 156 AC (use not disclosed)

