

LANE4

4,351 SF
AVAILABLE

MURAL/SIGNAGE
OPPORTUNITY

SIGNAGE



MISSION 7000 RETAIL SPACE FOR LEASE

7002 JOHNSON DR • MISSION, KS

SPENCER STEWART
816.268.9103 / ssewart@lane4group.com

MISSION 7000

- Retail space available in the heart of Mission
 - Also ideal for: restaurant, service, or medical
- Prime location on a hard corner with great visibility:
 - 39,000+ CPD on Metcalf Ave, and 23,000+ CPD on Johnson Dr

DEMOGRAPHICS	1 MI	3 MI	5 MI
Population	10,439	91,083	255,958
Average HH Income	\$91,927	\$100,907	\$111,738
# of Businesses	901	4,038	12,391
# of Employees	15,974	56,283	175,076



4,351 SF

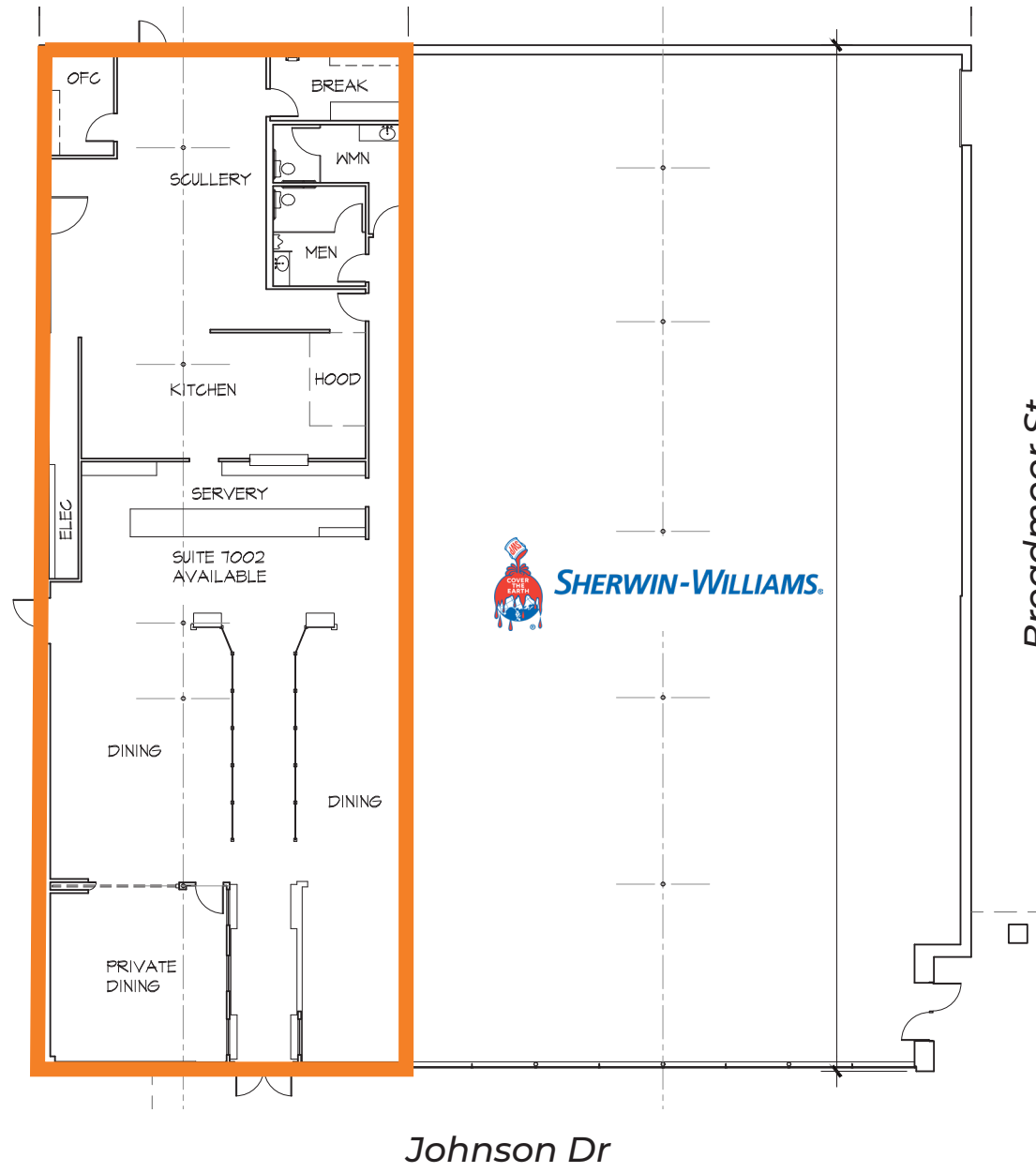

Broadmoor St

Johnson Dr





Merriam Town Center

CINEMARK
The Best Seat In Town

DICK'S SPORTING GOODS
Marshall's
PET SMART

THE HOME DEPOT
ROSS DRESS FOR LESS
OfficeMax

BOB'S FURNITURE
OLD NAVY **Walgreens**

Mission Apartments
307 Units
- Proposed -

Mission Gateway
Mixed-Use Development
- Proposed -

Fairway Apartments
221 Units, Under Construction

HOBBY LOBBY

23,671 CPD

Shawnee Mission North High School

169

NATURAL GROCERS

planet fitness

Johnson Dr

SITE

HyVee

Downtown Mission

BAR **ROCK CREEK** **Lalman's Donuts**

Sully's pub **The Point**

LONGBOARDS wraps & bowls **SANDHILL BREWING**

Shawnee Mission Pkwy

TARGET

39,164 CPD

63rd St

GENESIS

Antioch Rd

Metcalf Ave

Nail Ave

Roe Ave

The Village

hen house **ACE Hardware**

FRENCH MARKET **Caffetteria**

Duke **ELSTON** **bijin**

SCOOBIE **clique**

GOLDEN & PINE **Tavern**