



DOWNTOWN OLATHE REDEVELOPMENT



VIEW
rendering
flythrough

CHERRY STREET & SANTA FE DR, OLATHE, KS

Retail and Restaurant Opportunities

FULLY LEASED

Transformative Redevelopment Project

in the heart of Downtown Olathe

FULLY LEASED

- Located in a growing downtown of a vibrant Kansas City suburb
 - Since 2020: 5.95% population growth
 - 2010-2020: 12.5% population increase
- Project adjacent to Johnson County Square Park, a central meeting location for events with stage, garden, and sculptures
- 80-90 engaging community events annually including Fourth Fridays, Old Settlers, Farmer's Market, Arts Festival etc.
- Strong daytime population: 84,000 people (3 mi)
- LL to deliver space in warm grey shell condition with a grease service line through each space in Q2 2026
- Local ownership and management

SPENCER STEWART
816.268.9103 | sstewart@lane4group.com



WATCH
how Olathe
is growing



Adjacent to the new stage at the redeveloped Johnson Co. Square Park

NEW LOCAL CONCEPTS
coming to Downtown Olathe:

CHAR BAR



LANE4

Significant Investment Completed

exceeding \$250 million



- 1 Olathe Downtown Library
- 2 Johnson Co. Court House & City Hall
- 3 Johnson Co. Square Park
- 4 Arrello Apartments - 228 Units

WATCH
 how Downtown
 Olathe is
 transforming



Downtown Olathe Library



Johnson Co. Courthouse



Arrello Apartments - 228 Units



Johnson Co. Square Park



SITE PLAN

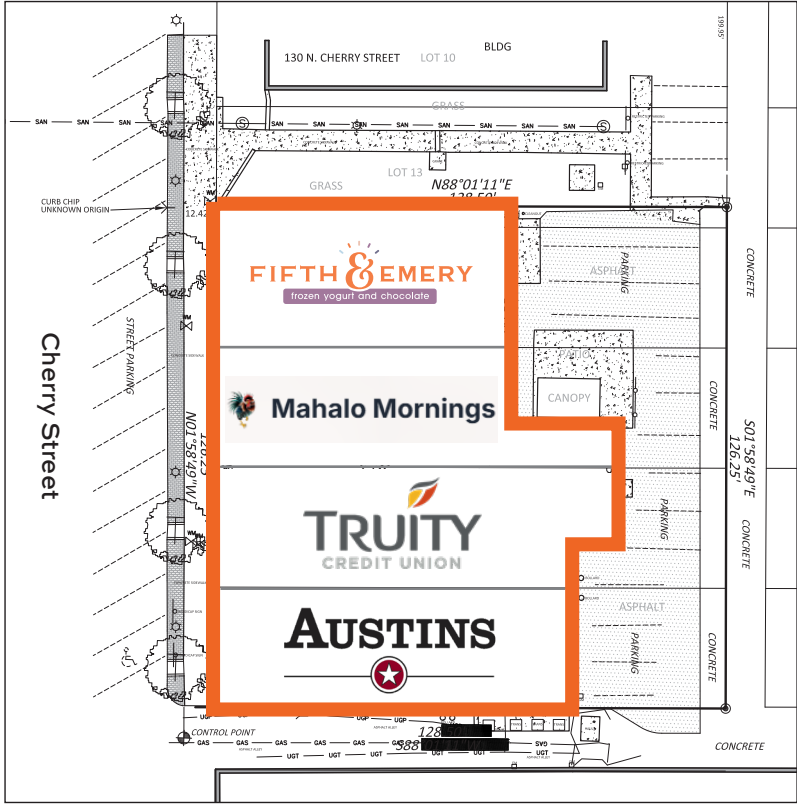



**DEDICATED
PARKING**

